



GEA Hygienic Pumps Assembly Toolkit

GEA Hygienic Pumps Assembly Toolkit

The specially designed tools make work easier and prevent damage to sensitive pump components.

Special tools for maintenance and service

The surfaces of parts that are in contact with the pumped liquid must be protected from mechanical damage during maintenance work.

When repairing and servicing sanitary pumps, care must be taken to ensure that the individual components of the pumps are not damaged. In the case of the GEA Hilge CONTRA range, if the unit is not assembled properly the pump shaft may bend and the impellers may rub against the pump housing.

GEA offers suitable tools for all maintenance and service issues. Items include fastening aids made of plastic as well as the socket spanner with plastic insert for loosening and tightening the impeller nut. Special FDA-approved lubricants for greasing components complete the overall contents of the Assembly Toolkit.

The Sanitary Assembly Toolkit includes the following special tools:

- Brass sleeves for mounting the mechanical seal on without bending or breaking of the seal
- Plastic sleeves for easy positioning of mechanical seals
- Ejector for easy disassembly of mechanical seals
- Plastic socket spanner inserts for loosening and fastening the impeller nut without any damage
- Impeller fastening aids for loosening and tightening the impeller nut



DATA

- | | | |
|---|---|---|
| <p>1 Assembly sleeve
 A Ø 19 mm
 B Ø 28 mm</p> <p>2 Spray bottle</p> <p>3 Assembly sleeve
 A Ø 50 mm
 B Ø 40 mm
 C Ø 30 mm
 D Ø 22 mm
 E Ø 19 mm</p> <p>4 A Plastic adapter Ø 40 mm
 B Assembly sleeve Ø 38 mm
 C Plastic adapter Ø 22 mm
 D Plastic adapter Ø 30 mm</p> <p>5 Ejector for mechanical seal – stationary ring</p> | <p>6 Kluber paste UH1 84-201</p> <p>7 27 mm PTFE lined socket × ½" drive</p> <p>8 Optimol paste TA</p> <p>9 17 mm PTFE lined socket × ½" drive</p> <p>10 Loctite screw locking type 24 3</p> <p>11 10 mm PTFE lined socket × ½" drive</p> <p>12 Mechanical seal installation sleeve with plastic adapter
 A Ø 50 mm
 B Ø 38 mm
 C Ø 28 mm
 D Ø 19 mm</p> <p>13 A to D impeller – fastening aids</p> <p>14 Cross bar handle with ½" drive</p> <p>15 Adjusting sleeves</p> <p>16 Retainer tool</p> | <p>17 Impeller holding/centering wrench</p> <p>18 Disassembly tool for GEA Hilge NOVALOBE mechanical seal</p> <p>19 Distance/Spacing Plates for GEA Hilge TP/TPS</p> |
|---|---|---|

- Included in the Assembly Toolkit
- Not included in the Assembly Toolkit

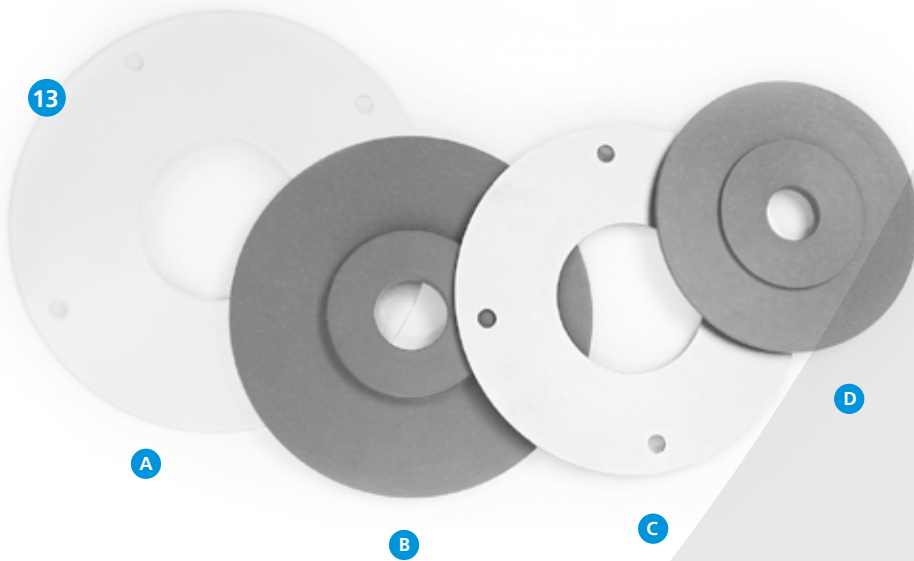
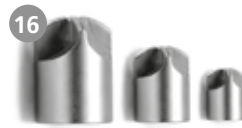
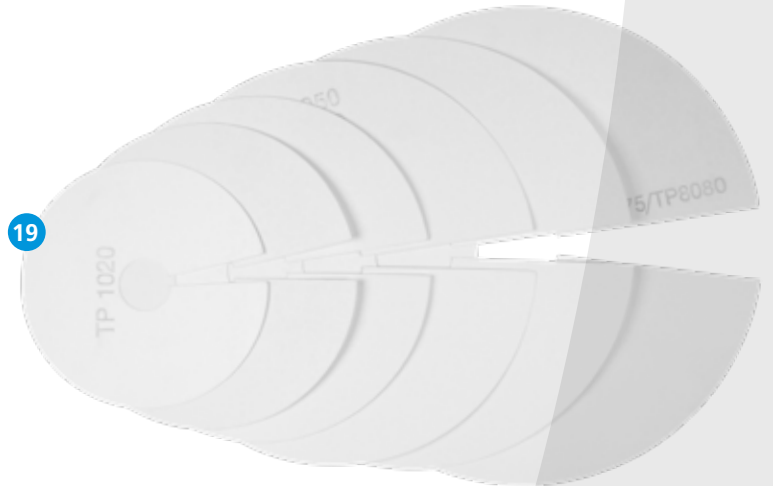
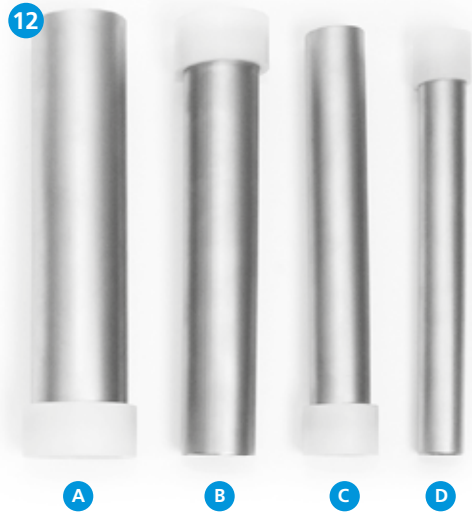
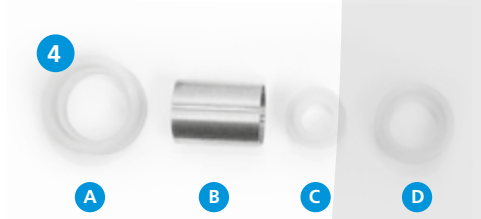
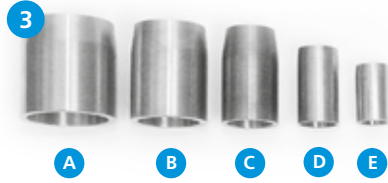
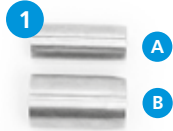



We live our values.

Excellence • Passion • Integrity • Responsibility • GEA-versity

GEA is a global technology company with multi-billion euro sales operations in more than 50 countries. Founded in 1881 the company is one of the largest providers of innovative equipment and process technology. GEA is listed in the STOXX® Europe 600 Index. In addition, the company is included in selected MSCI Global Sustainability Indexes.

GEA Germany

GEA Hilge

Niederlassung der GEA Tuchenhagen GmbH

Hilgestraße 37–47

55294 Bodenheim, Germany

Tel +49 6135 7016-0

Fax +49 6135 1737

sales.germany@gea.com

gea.com