



GEA Hygienic Pumps Assembly Toolkit



engineering for
a better world

gea.com

GEA Hygienic Pumps Assembly Toolkit

The specially designed tools make work easier and prevent damage to sensitive pump components.

Special tools for maintenance and service

The surfaces of parts that are in contact with the pumped liquid must be protected from mechanical damage during maintenance work.

When repairing and servicing sanitary pumps, care must be taken to ensure that the individual components of the pumps are not damaged. In the case of the GEA Hilge CONTRA range, if the unit is not assembled properly the pump shaft may bend and the impellers may rub against the pump housing.

GEA offers suitable tools for all maintenance and service issues. Items include fastening aids made of plastic as well as the socket spanner with plastic insert for loosening and tightening the impeller nut. Special FDA-approved lubricants for greasing components complete the overall contents of the Assembly Toolkit.

The Sanitary Assembly Toolkit includes the following special tools:

- Brass sleeves for mounting the mechanical seal on without bending or breaking of the seal
- Plastic sleeves for easy positioning of mechanical seals
- Ejector for easy disassembly of mechanical seals
- Plastic socket spanner inserts for loosening and fastening the impeller nut without any damage
- Impeller fastening aids for loosening and tightening the impeller nut

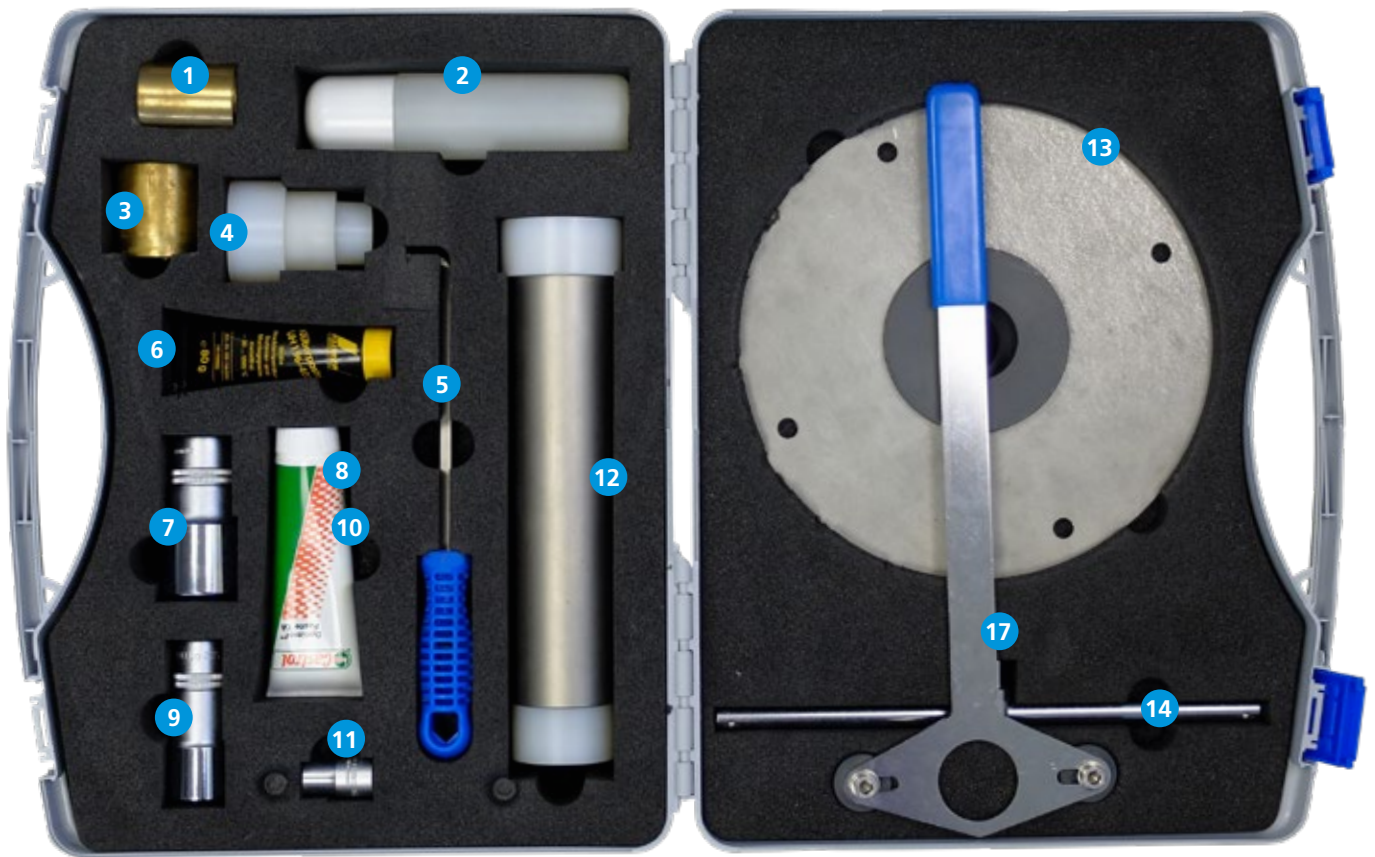

DATA

- | | | |
|---|---|---|
| <p>1 Assembly sleeve
 A Ø 19 mm
 B Ø 28 mm</p> <p>2 Spray bottle</p> <p>3 Assembly sleeve
 A Ø 50 mm
 B Ø 40 mm
 C Ø 30 mm
 D Ø 22 mm
 E Ø 19 mm</p> <p>4 A Plastic adapter Ø 40 mm
 B Assembly sleeve Ø 38 mm
 C Plastic adapter Ø 22 mm
 D Plastic adapter Ø 30 mm</p> <p>5 Ejector for mechanical seal – stationary ring</p> | <p>6 Kluber paste UH1 84-201</p> <p>7 27 mm PTFE lined socket × ½" drive</p> <p>8 Optimol paste TA</p> <p>9 17 mm PTFE lined socket × ½" drive</p> <p>10 Loctite screw locking type 24 3</p> <p>11 10 mm PTFE lined socket × ½" drive</p> <p>12 Mechanical seal installation sleeve with plastic adapter
 A Ø 50 mm
 B Ø 38 mm
 C Ø 28 mm
 D Ø 19 mm</p> <p>13 A to D impeller – fastening aids</p> <p>14 Cross bar handle with ½" drive</p> <p>15 Adjusting sleeves</p> <p>16 Retainer tool</p> | <p>17 Impeller holding/centering wrench</p> <p>18 Disassembly tool for GEA Hilge NOVALOBE mechanical seal</p> <p>19 Distance/Spacing Plates for GEA Hilge TP/TPS</p> |
|---|---|---|

- Included in the Assembly Toolkit
- Not included in the Assembly Toolkit

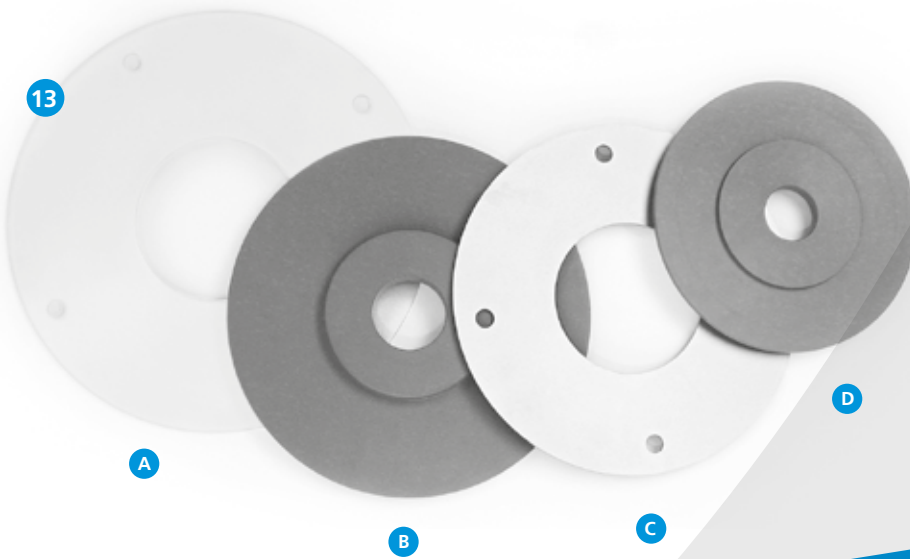
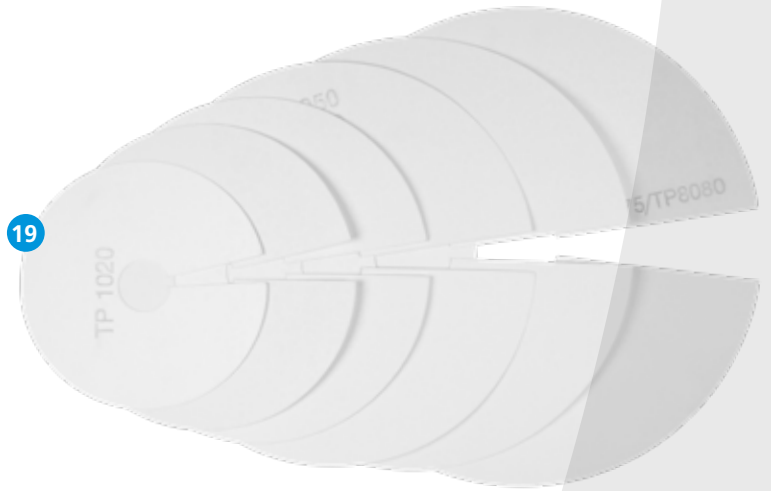
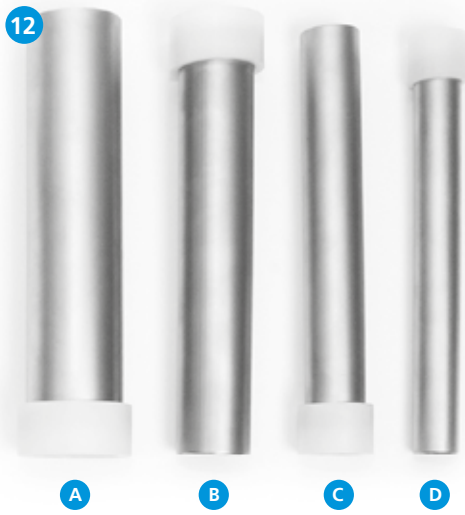
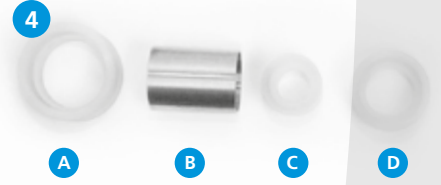
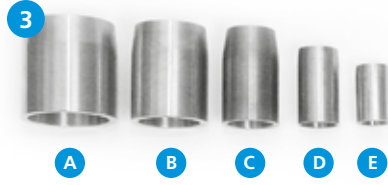
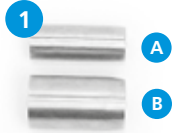

OVERVIEW

Description	SAP-no.	GEA Hilge HYGIA I	GEA Hilge HYGIA II	GEA Hilge HYGIA III	GEA Hilge CONTRA I	GEA Hilge CONTRA II	GEA Hilge DURIETTA 0	GEA Hilge DURIETTA I	GEA Hilge MAXA 80-160	GEA Hilge MAXA 100-200 / 100-250 / 100-315 / 125-250 / 80-200 / 80-250 / 80-315	GEA Hilge MAXA 125-315 / 150-250 / 150-315 / 150-400 / 200-400	GEA Hilge MAXANA except 65-250	GEA Hilge MAXA / MAXANA 65-250	NORM-Durachrom	GEA Hilge SIPLA 3.1	GEA Hilge SIPLA 6.1 / 12.1 / 18.1 / 28.1 / 52.1	GEA Hilge SIPLA 65.1 / 90.1	GEA Hilge HYGIANA I	GEA Hilge HYGIANA II	GEA Hilge HYGIANA III	GEA Hilge NOVALOBE 10	GEA Hilge NOVALOBE 20	GEA Hilge NOVALOBE 30	GEA Hilge NOVALOBE 40	GEA Hilge NOVALOBE 50	GEA Hilge TP/TPS
Shaft diameter (mm)		19	28	38	19	28	19	19	30	40	50	30	40	22	19	28	38	19	28	38	22	27	38	53	63	
Complete Assembly Toolkit	95089139	•	•	•	•	•	•	•	•	•	•	•	•	•	•	•	•	•	•	•	•	•	•	•	•	•
1 A Assembly sleeve Ø 19 mm	96765890	•			•			•							•			•								•
B Assembly sleeve Ø 28 mm	96799750		•			•										•			•							
2 Spray bottle	96744453	•	•	•	•	•	•	•	•	•	•	•	•	•	•	•	•	•	•	•	•	•	•	•	•	•
3 A Assembly sleeve Ø 50 mm	96799802									•																
B Assembly sleeve Ø 40 mm	96799760								•				•													
C Assembly sleeve Ø 30 mm	96799757							•				•														
D Assembly sleeve Ø 22 mm	96799509														•											
E Assembly sleeve Ø 19 mm	96799506						•																			
4 A Plastic adapter Ø 40 mm	96799414								•				•													
B Assembly sleeve Ø 38 mm	96799759			•													•			•						
C Plastic adapter Ø 22 mm	96799416													•												
D Plastic adapter Ø 30 mm	96799417							•				•														
5 Ejector for mechanical seal	96799029	•	•	•	•	•	•	•	•	•	•	•	•	•	•	•	•	•	•	•	•	•	•	•	•	•
6 Klüber paste UH1 84-201	96784411	•	•	•	•	•	•	•	•	•	•	•	•	•	•	•	•	•	•	•	•	•	•	•	•	•
7 Socket wrench, width across flats 32	96798954		•			•										•			•							
Insert for Socket wrench, width across flats 27	96798990		•			•										•			•							
8 Optimol paste TA	96799803	•	•	•	•	•	•	•	•	•	•	•	•	•	•	•	•	•	•	•	•	•	•	•	•	•
9 Socket wrench, width across flats 24	96798987	•			•											•			•							
Insert for Socket wrench, width across flats 17	96799003	•			•											•			•							
10 Loctite screw locking type 24 3	96799889	•	•	•	•	•	•	•	•	•	•	•	•	•	•	•	•	•	•	•	•	•	•	•	•	•
11 Socket wrench, width across flats 14	97549370	•	•		•	•													•	•						
Insert for Socket wrench, width across flats 10	96799006	•	•		•	•													•	•						
12 A Mechanical seal installation sleeve Ø 50 mm	96799320									•																
A Plastic adapter Ø 50 mm	96799377									•																
B Mechanical seal installation sleeve Ø 38 + 40 mm	96799344			•					•				•				•			•						
B Plastic adapter Ø 38 mm	96799395			•													•			•						
C Mechanical seal installation sleeve Ø 28 + 30 mm	96799351		•			•		•				•				•			•							
C Plastic adapter Ø 28 mm	96799413		•			•						•				•			•							
D Mechanical seal installation sleeve Ø 19 + 22 mm	96799372	•			•		•	•						•	•				•							
D Plastic adapter Ø 19 mm	96799418	•			•		•	•							•				•							
13 A Impeller centering wrench	96799095					•																				
B Impeller centering wrench, plastic	96799915					•																				
C Impeller centering wrench	96799099				•																					
D Impeller centering wrench, plastic	96799917				•																					
14 Cross bar handle with ½" drive	96799887	•	•		•	•		•	•			•	•		•	•		•	•							
15 A Adjusting sleeves Ø 19 mm	97725282																									
B Adjusting sleeves Ø 28 mm	97777831																									
16 A Retainer tool 10	97747682																				•					
B Retainer tool 20 & 30	97747696																					•	•			
C Retainer tool 40 & 50	97747704																						•	•		
17 Impeller holding/centering wrench	97562553	•	•	•																						
18 Disassembly tool for mechanical seal 10	96884744																				•					
Disassembly tool for mechanical seal 20	96884743																					•				
Disassembly tool for mechanical seal 30	96884730																						•			
Disassembly tool for mechanical seal 40	96884728																							•		
Disassembly tool for mechanical seal 50	96884727																								•	
19 Distance/Spacing Plates GEA Hilge TP/TPS	244-002360																									•

● Included in the Assembly Toolkit ● Not included in the Assembly Toolkit



We live our values.

Excellence • Passion • Integrity • Responsibility • GEA-versity

GEA is a global technology company with multi-billion euro sales operations in more than 50 countries. Founded in 1881 the company is one of the largest providers of innovative equipment and process technology. GEA is listed in the STOXX® Europe 600 Index. In addition, the company is included in selected MSCI Global Sustainability Indexes.

GEA Germany

GEA Hilge

Niederlassung der GEA Tuchenhagen GmbH

Hilgestraße 37–47

55294 Bodenheim, Germany

Tel +49 6135 7016-0

Fax +49 6135 1737

sales.germany@gea.com

gea.com